

PSECO

**TRANSIT VEHICLE WASH
SPECIALISTS**

HIGH PRESSURE, (TOUCHLESS) DRIVE-THRU BUS/TRUCK WASH

Model DTHP12 Maximum Vehicle Height 12 ft.

Model DTHP14 Maximum Vehicle Height 14 ft.

The high pressure wash is for all vehicles that do not have smooth, flat surfaces. The high pressure water jets combined with the correct chemical mixture reach into all corners, and are ideal for garbage trucks, tankers, construction and military vehicles.

STANDARD FEATURES

- 1 x Pre-Rinse & Foamer Arch
- 4 x Electric Eye Actuators
- 1 x Spinner Arch c/w
13 Spinning Nozzle Heads
(For 12 foot vehicles)
15 Spinning Nozzle Heads
(For 14 foot vehicles)
- 1 x 50 HP Pump/Tank Assembly
- 1 x Hydrominder/Chemical Pump/
Foamer Station Assemblies
- 1 x 55ft Fixed Guide Rails
c/w Epoxy Anchors
- 1 x Final Rinse Arch
- 1 x MCC c/w PLC base controls
- 1 x Pneumatic Panel
- 1 x Utility Racks
- 1 x 2" Water Make Up Solenoid
- 1 x Entrance Signal

OPTIONS

- Two step chemical application arch
- Chassis wash
- Wheel wash
- Water reclaim
- Blower/Dryer
- Stainless Steel skid plates
- Auto door control
- Splash curtains
- Water softener
- Water heater



PSECO Inc.

6201 Hwy 7, Unit 4, Woodbridge, Ontario L4H 0K7

Tel: (905) 850-1887

Fax: (905) 850-2192

HIGH PRESSURE, TOUCHLESS, DRIVE THRU WASH

- 1 Pre-Rinse/Detergent Arch
- 2 High Pressure Spinner Arch
- 3 Sensor Actuator
- 4 Set of Wheel Guide Rails (fixed)
- 5 Final Rinse Arch
- 6 Electrical Control Panel (not shown)
- 7 Detergent Feed/Metering system (not shown)
- 8 Spinner Pump 50hp (not shown)
- 9 Water Tank (not shown)

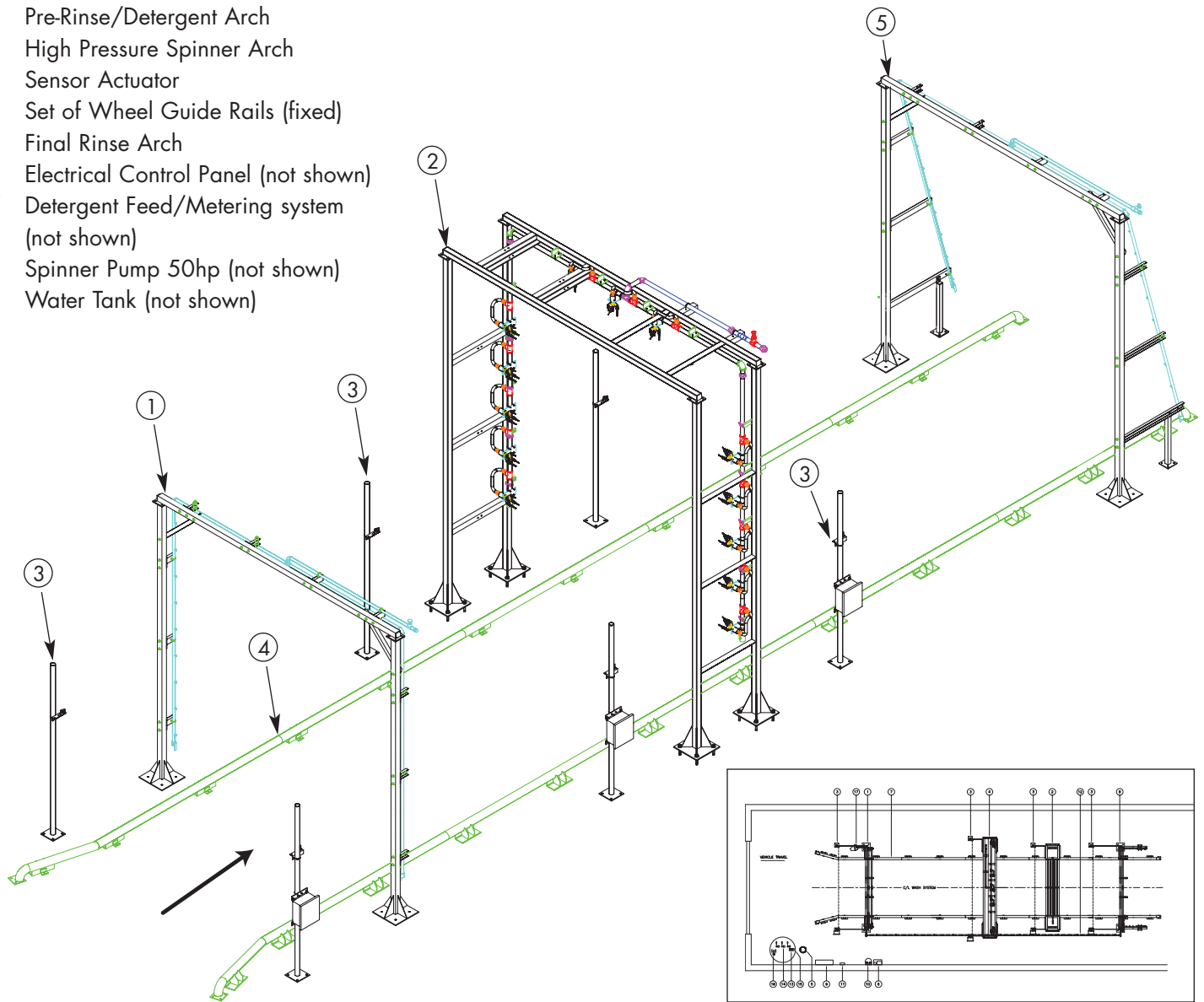

MAIN SERVICE REQUIREMENTS			
ELECTRICAL	AT 220V	AT 460V	AT 575V
ADD FOR HIGH PRESSURE SPINNERS (50 HP)	200 A	100 A	80 A
ADD FOR WASH WATER RECYCLE SYSTEM (TWO X 7.5 HP)	50 A	25 A	20 A
COMPRESSED AIR	1/2" AIR LINE AT 80 PSI		
WATER	2" MINIMUM COLD WATER LINE AT 50 PSI (DRAIN AND SEWAGE PER LOCAL CODES)		

NOTE:

1. Actual locations of equipment may vary from that shown to meet field conditions.
2. Consult Pseco Inc. for information on installations in smaller washbays, or larger vehicles.
3. Space Preferred: Length 80', Width 20', Height 18'.

PSECO Inc.

6201 Hwy 7, Unit 4, Woodbridge, Ontario L4H 0K7

Tel: (905) 850-1887

Fax: (905) 850-2192